

LOCATION MAP N.T.S.

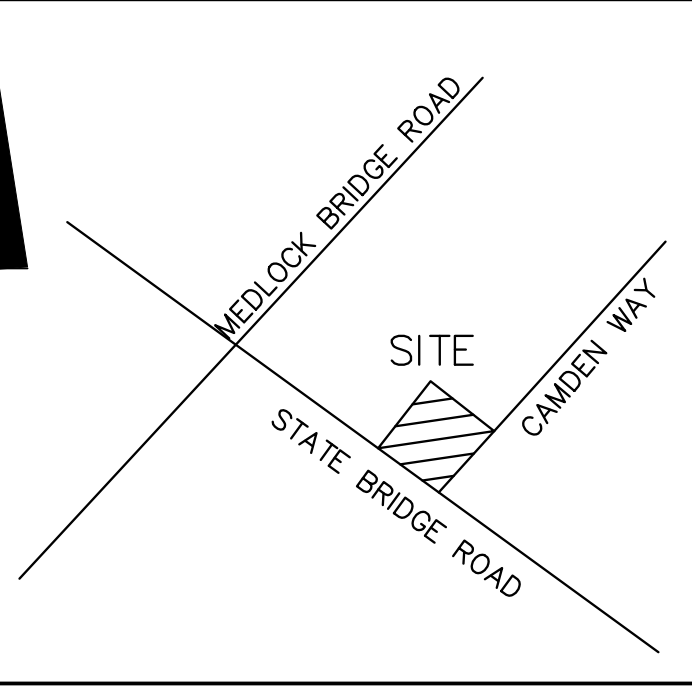

VICINITY MAP N.T.S.

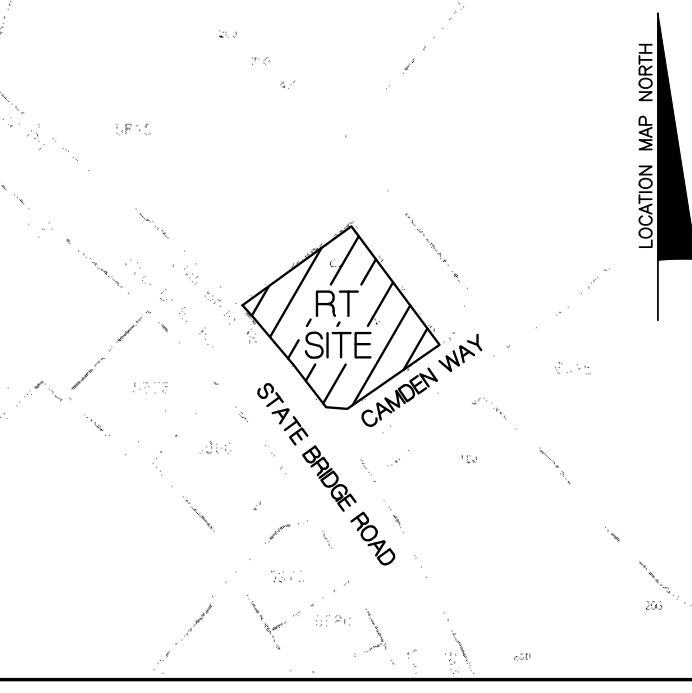

**SITE DATA TABLE**

SITE AREA:	2.30 ACRES
BUILDING COVERAGE:	STORE 0.12 AC. 5%
	CANOPY 0.16 AC. 6%
	TOTAL 0.28 AC. 10%
UNBUILDABLE LAND:	0.4 AC. 17%
BUILDABLE LAND:	1.9 AC. 83%
PARKING SPACES:	
PROVIDED (30 STD., 2 HDOP)	= 32 SF
GFA:	= 5411 SF
MIN. REQUIRED:	(GFA/200)
	(5,411/200) = 27 SF
BUILDING SETBACKS:	
FRONT (STATE BRIDGE ROAD)	40 FT.
FRONT (CAMDEN WAY)	0 FT.
REAR	0 FT.
SIDE	0 FT.
AREA BREAKOUT:	
PERVIOUS	EXISTING 17,796 SF (82%)
	PROPOSED 46,309 SF (46%)
IMPERVIOUS	EXISTING 82,548 SF (82%)
	PROPOSED 54,035 SF (54%)
ZONING/LAND USE:	
PARCEL ZONING	"C-1"
SURROUNDING ZONING	"C-1" AND "A"

- LEGEND**
- EXISTING STORM PIPE
  - PROPOSED STORM PIPE
  - DW/CB EXISTING DOUBLE WING CATCH BASIN
  - SW/CB PROPOSED DOUBLE WING CATCH BASIN
  - SW/CB EXISTING SINGLE WING CATCH BASIN
  - SW/CB PROPOSED SINGLE WING CATCH BASIN
  - DI EXISTING DROP INLET
  - DI / CI PROPOSED DROP INLET / CURB INLET
  - Y EXISTING HOODED YARD INLET
  - YI PROPOSED HOODED YARD INLET
  - JB EXISTING JUNCTION BOX
  - JB PROPOSED JUNCTION BOX
  - HW EXISTING HEADWALL
  - HW PROPOSED HEADWALL
  - S/S EXISTING SANITARY SEWER
  - S/S PROPOSED SANITARY SEWER
  - SEWER EXISTING SANITARY SEWER MANHOLE
  - SSMH EXISTING SANITARY SEWER MANHOLE
  - CO EXISTING CLEAN OUT
  - CO PROPOSED CLEAN OUT
  - WATER EXISTING WATER
  - WATER PROPOSED DOMESTIC WATER
  - FIRE EXISTING FIRE LINE
  - WV EXISTING WATER VALVE
  - WV PROPOSED WATER VALVE
  - WM EXISTING WATER METER
  - WM PROPOSED WATER METER
  - BP EXISTING BACKFLOW PREVENTER
  - BP PROPOSED BACKFLOW PREVENTER
  - FH EXISTING FIRE HYDRANT
  - FH PROPOSED FIRE HYDRANT
  - IGV EXISTING IRRIGATION CONTROL VALVE
  - IGV PROPOSED IRRIGATION CONTROL VALVE
  - UP EXISTING UNDERGROUND POWER
  - UP PROPOSED UNDERGROUND POWER
  - UT EXISTING UNDERGROUND TELEPHONE
  - UT PROPOSED UNDERGROUND TELEPHONE
  - TELE EXISTING OVERHEAD TELEPHONE
  - TELE PROPOSED OVERHEAD TELEPHONE
  - FT EXISTING AREA LIGHT
  - FT PROPOSED AREA LIGHT
  - AL EXISTING STREET LIGHT
  - AL PROPOSED STREET LIGHT
  - UT EXISTING UTILITY POLE
  - UT PROPOSED UTILITY POLE
  - GW EXISTING GUY WIRE ANCHOR
  - GW PROPOSED GUY WIRE ANCHOR
  - TRANS EXISTING TRANSFORMER
  - TRANS PROPOSED TRANSFORMER
  - MW EXISTING MONITORING WELL
  - MW PROPOSED MONITORING WELL
  - R2M EXISTING RIGHT-OF-WAY MONUMENT FOUND
  - R2M PROPOSED RIGHT-OF-WAY MONUMENT FOUND
  - IPF EXISTING IRON PIN FOUND
  - IPF PROPOSED IRON PIN FOUND
  - IPF EXISTING IRON PIN SET
  - IPF PROPOSED IRON PIN SET
  - POB EXISTING POINT OF BEGINNING
  - POB PROPOSED POINT OF BEGINNING
  - R/W EXISTING RIGHT-OF-WAY
  - R/W PROPOSED RIGHT-OF-WAY
  - CL EXISTING CENTER LINE
  - CL PROPOSED CENTER LINE
  - L/S EXISTING LANDSCAPE AREA
  - L/S PROPOSED LANDSCAPE AREA
  - TOP EXISTING TOP OF WALL
  - TOP PROPOSED TOP OF WALL
  - BOW EXISTING BOTTOM OF WALL
  - BOW PROPOSED BOTTOM OF WALL
  - FCC EXISTING FACE OF CURB
  - FCC PROPOSED FACE OF CURB
  - BOC EXISTING BACK OF CURB
  - BOC PROPOSED BACK OF CURB
  - EOP EXISTING EDGE OF PAVEMENT
  - EOP PROPOSED EDGE OF PAVEMENT
  - M.E.G. EXISTING MATCH EXISTING GRADE
  - M.E.G. PROPOSED MATCH EXISTING GRADE
  - XY EXISTING EXISTING FENCE
  - XY PROPOSED EXISTING FENCE
  - O EXISTING PROPOSED CHAINLINK FENCE
  - O PROPOSED CHAINLINK FENCE
  - W EXISTING WOODEN FENCE
  - W PROPOSED WOODEN FENCE
  - GAS EXISTING GAS
  - GAS PROPOSED GAS
  - FIBER EXISTING FIBER OPTIC
  - FIBER PROPOSED FIBER OPTIC
  - UCTV EXISTING UNDERGROUND CABLE
  - UCTV PROPOSED UNDERGROUND CABLE
  - CTV EXISTING OVERHEAD CABLE
  - CTV PROPOSED OVERHEAD CABLE
  - TC EXISTING TRAFFIC CONTROL
  - TC PROPOSED TRAFFIC CONTROL
  - X EXISTING EXISTING SILT FENCE
  - X PROPOSED EXISTING SILT FENCE
  - TF EXISTING EXISTING TREE FENCE
  - TF PROPOSED EXISTING TREE FENCE

**Harkleroad and Associates**  
 Engineers & Land Surveyors  
 1608 Tree Lane, Building A, Suite 100, Marietta, Ga. 30078  
 Phone (770) 982-1996 / Fax: (770) 982-1998  
 HARKLEROAD PROJECT 6191

THESE PLANS ARE SUBJECT TO FEDERAL COPYRIGHT LAWS. ANY USE OF SAME WITHOUT THE EXPRESSED WRITTEN PERMISSION OF HARKLEROAD AND ASSOCIATES, INC. IS PROHIBITED.

**RaceTrac**  
 RACETRAC PETROLEUM, INC.  
 200 GALLERIA PARKWAY S.E., SUITE 900  
 SUITE 100 ATLANTA, GA. 30339  
 (770) 431-7600

**SITE PLAN**  
 RACETRAC STORE TBD  
 5805 STATE BRIDGE ROAD  
 LL 330 & 331 1ST DISTRICT, 1ST SECTION  
 CITY OF JOHNS CREEK  
 FULTON COUNTY, GEORGIA

DATE: 11/28/2018  
 SCALE: 1"=20'  
 DRAWN BY: RD  
 DRAWING NAME: 6191cp.dwg  
**C3.0**  
 SHEET NO. REVISION

RECEIVED  
 NOV 28 2018  
 City of Johns Creek  
 Community Development  
 R2-19-003



H:\6191\6191.dwg 6/19/18 11:28:20 AM Nov 28, 2018 - 3:05pm