

LEGEND

- CTP = CRIMP TOP PIPE
- IPF = IRON PIN FOUND
- OTP = OPEN TOP PIPE
- RBF = REBAR PIN FOUND
- IPS = 1/2" REBAR PIN SET
- R/W = RIGHT OF WAY
- LL = LAND LOT
- LLL = LAND LOT LINE
- SSE = SANITARY SEWER EASEMENT
- DE = DRAINAGE EASEMENT
- UE = UTILITY EASEMENT
- PL = PROPERTY LINE
- BL = BUILDING LINE
- CL = CENTERLINE
- EP = EDGE OF PAVEMENT
- BOC = BACK OF CURB
- MH = MAN HOLE
- CB = CATCH BASIN
- JB = JUNCTION BOX
- DI = DROP INLET
- HW = HEAD WALL
- PP = POWER POLE
- FH = FIRE HYDRANT
- IE = INVERT ELEVATION
- FFE = FINISHED FLOOR ELEVATION
- S- = SANITARY SEWER LINE/PIPE
- SS- = STORM SEWER LINE/PIPE
- X- = FENCE LINE
- ooo = FLOOD HAZARD ZONE LINE
- N/F = NOW OR FORMERLY

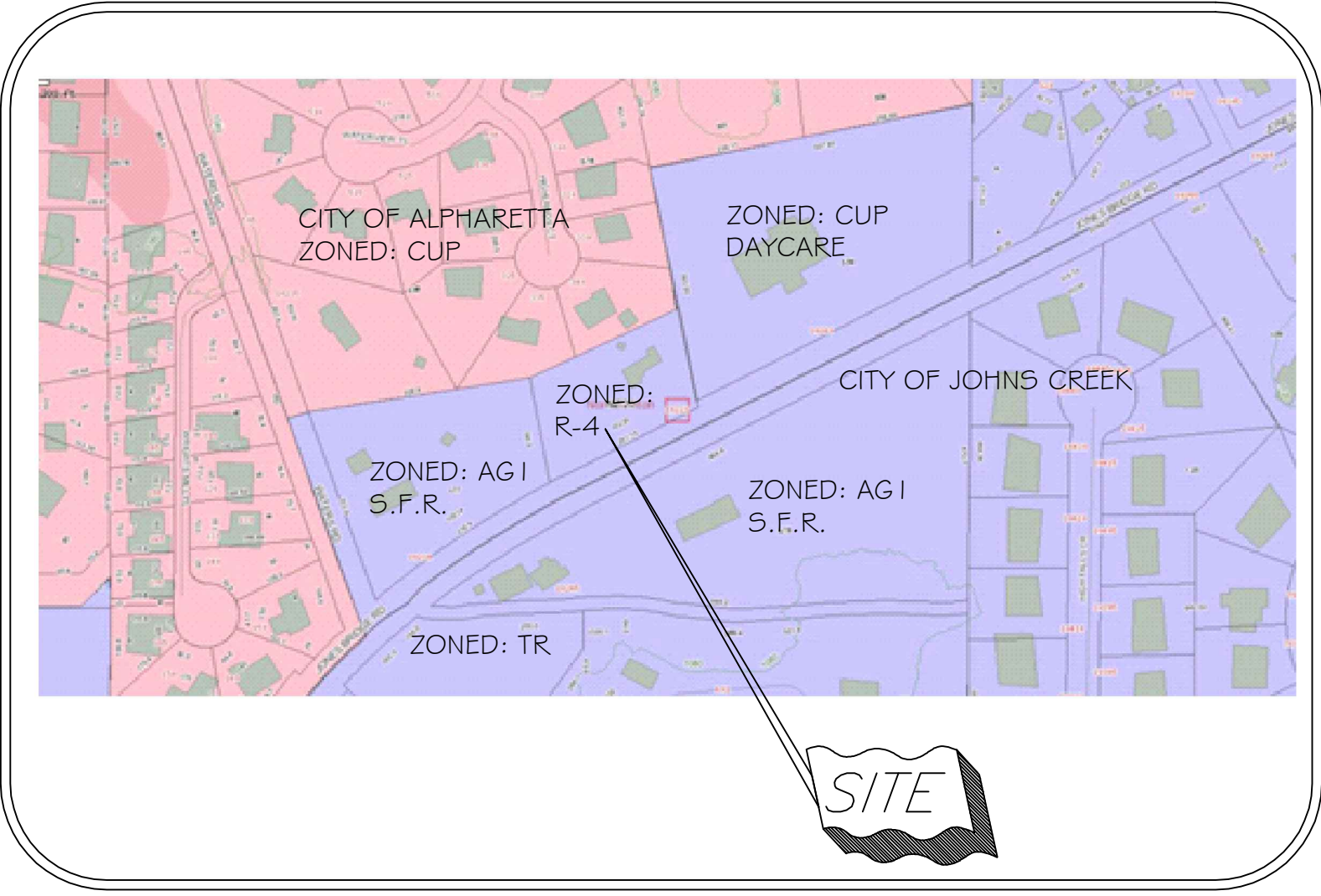

VICINITY MAP
(NOT TO SCALE)

NOTES:
 TREE SAVE FENCE NOT NECESSARY IF (Sd1) IS INSTALLED AND MAINTAINED.
 ALL DISTURBED AREAS ARE TO BE MULCHED AND/OR VEGETATED. (Ds1, Ds2, Ds3, Ds4).
 TOTAL DISTURBED AREA > 5000 SQ. FT. REQUIRED WATER QUALITY ON SITE UNLESS PROVIDED FOR IN TOTAL STORM WATER MANAGEMENT PROGRAM ON SITE.

DESIGN, INSTALL, AND MAINTAIN ALL BMP'S.
 LIMITS OF CONSTRUCTION TO SERVE AS TREE SAVE.
 CITY OF JOHN'S CREEK PERSONNEL AND OR AGENTS SHALL HAVE FREE AND TOTAL ACCESS TO, ACROSS, AND UNDER DRIVEWAYS, THAT WILL BE INSTALLED ON THIS RECORDED LOT, FOR THE PURPOSE OF INSPECTION, REPAIR, AND/OR CONSTRUCTION, AND SHALL HAVE NO RESPONSIBILITY FOR DAMAGES TO, OR THE REPAIR OF IMPROVEMENTS
 REINFORCED WALLS (Re) IF EXTENDED 20' BEYOND HOUSE FOUNDATION. OVER 4FT. HIGH REQUIRES ENGINEER'S CERTIFICATION.

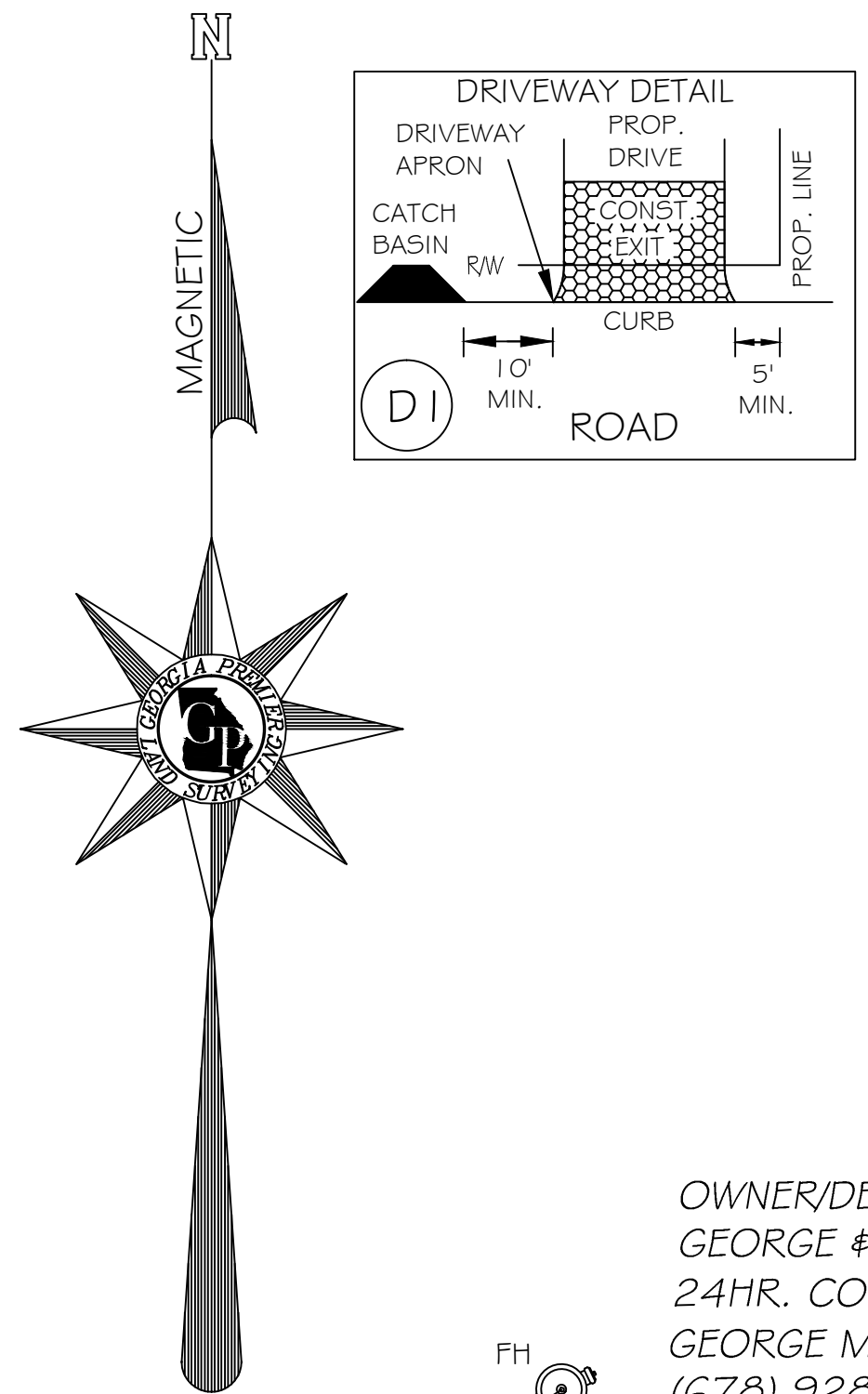

THIS MAP OR PLAT HAS BEEN CALCULATED FOR CLOSURE AND IS FOUND TO BE ACCURATE WITHIN ONE FOOT IN 453,639 FEET AND CONTAINS 0.900 ACRES.

REFERENCES:

1. WARRANTY DEED RECORDED IN DEED BOOK 48843 PAGE 109, FULTON COUNTY RECORDS.

NOTES:

1. 1' CONTOUR INTERVALS SHOWN.
2. ELEVATION BASED ON FULTON COUNTY GIS
3. PROPERTY ADDRESS:
10220 JONES BRIDGE RD.
JONES CREEK, GA 30022

A TOPCON GTS-235 TOTAL STATION WAS USED TO OBTAIN THE LINEAR AND ANGULAR MEASUREMENTS USED IN THE PREPARATION OF THIS PLAT.

THE FIELD DATA UPON WHICH THIS MAP OR PLAT IS BASED HAS A CLOSURE PRECISION OF ONE FOOT IN 18,435 FEET AND AN ANGULAR ERROR OF 02" PER ANGLE POINT, AND WAS ADJUSTED USING THE LEAST SQUARES METHOD.

THIS MAP OR PLAT HAS BEEN CALCULATED FOR CLOSURE AND IS FOUND TO BE ACCURATE WITHIN ONE FOOT IN 453,639 FEET AND CONTAINS 0.900 ACRES.

N/F
EBENEZER ROAD VENTURE, LLC.
D.B.41583 P.G.160
ZONED

PROPERTY ZONED R-4
 PROPOSED TO BE CHANGED TO R-6 W/ USE PERMIT UNDER ARTICLE 19.4.33.
 PERSONAL CARE HOME / ASSISTED LIVING FACILITY FOR UP TO 12 OCCUPANTS.
 PROPOSED FACILITY TO BE OPEN TO VISITORS MON.-SUN. 9AM-7PM. 24-HR. ROUND THE CLOCK CARE & STAFF FOR OCCUPANTS.

Total Acres = 0.900
 Total Ac. Dist. = ±0.70

BUILDING COVERAGE: 9,093 S.F. W/ PORTE COCHERE
 TOTAL PAVED AREA: 7,210 S.F.
 LANDSCAPE AREA: 22,880 S.F.

SITE PLAN FOR:
GEORGE & ELENA MARTENIUC
 10220 JONES BRIDGE RD.
 JONES CREEK, GA 30022

DATE: 3.31.2011
 LEGAL DESCRIPTION:

ALL THAT TRACT OR PARCEL OF LAND LYING IN AND BEING IN LAND LOT 58 OF THE 1ST. LAND DISTRICT, 1ST. SECTION OF FULTON COUNTY GEORGIA, AND BEING MORE PARTICULARLY DESCRIBED AS FOLLOWS:
 COMMENCE AT THE INTERSECTION OF THE EASTERLY RIGHT OF WAY OF WATERS ROAD (60' RIGHT OF WAY) AND THE NORTHERLY RIGHT OF WAY OF JONES BRIDGE ROAD (RW VARIES) THENCE ALONG THE NORTHERLY RIGHT OF WAY OF JONES BRIDGE ROAD IN AN EASTERLY DIRECTION FOR A DISTANCE OF 319.26 FEET TO A POINT, SAID POINT BEING MARKED BY A 1/2 INCH REBAR FOUND, SAID POINT BEING THE TRUE POINT OF BEGINNING. THENCE ALONG SAID RIGHT OF WAY NORTH 14 DEGREES 48 MINUTES 36 SECONDS WEST OF FOR A DISTANCE OF 181.05 FEET TO A POINT, SAID POINT BEING MARKED BY A 1/2 INCH REBAR SET; THENCE NORTH 70 DEGREES 10 MINUTES 08 SECONDS EAST FOR A DISTANCE OF 245.84 FEET TO A POINT, SAID POINT BEING MARKED BY A 1/2 INCH REBAR FOUND ON THE NORTHERLY RIGHT OF WAY OF JONES BRIDGE ROAD (RW VARIES), THENCE ALONG SAID RIGHT OF WAY SOUTH 61 DEGREES 33 MINUTES 30 SECONDS WEST FOR A DISTANCE OF 244.55 FEET TO A POINT, SAID POINT BEING A 1/2 INCH REBAR FOUND AND SAID POINT BEING THE TRUE POINT OF BEGINNING.
 TOGETHER WITH THE SUBJECT TO A COVENANTS, EASEMENT, AND RESTRICTIONS OF RECORD, SAID PROPERTY CONTAINS 0.900 ACRES AS SHOWN ON SITE PLAN.

NO CONSTRUCTION ACTIVITIES SHALL OCCUR WITHIN ANY PROPERTY PURCHASED BY THE CITY FOR OWNERSHIP OR CONSTRUCTION UNTIL THE COMPLETION OF THE JONES BRIDGE ROAD AT WATERS ROAD INTERSECTION IMPROVEMENTS INCLUDES CONSTRUCTION AND DRIVEWAY

POB 319.26' ARC
 TO THE EASTERLY RW OF WATERS ROAD.

DISTANCE PROFILE ASSUMING DRIVER'S EYE HEIGHT @ 3.5'

TPOB
 1/2"RBF

REDUCED PRESSURE BACK-FLOW ASSEMBLY
 1-1/2" WATER METER

WATERLINE PEDISTAL

PLANTED LEYLAND CYPRESS
 6' TALL OBSCURE WOOD FENCE

PLANTED LEYLAND CYPRESS
 6' TALL OBSCURE WOOD FENCE

N/F
 MICHAEL & MINDY GOLDENBURG
 D.B.31201 P.G.137
 ZONED

OWNER/DEVELOPER
 GEORGE & ELENA MARTENIUC
 24HR. CONTACT:
 GEORGE MARTENIUC
 (678) 928-1665

Ds1 TEMPORARY STABILIZATION (MULCHING)

WHEN SEEDING WILL NOT HAVE A SUITABLE GROWING SEASON TEMPORARY STABILIZATION MAY BE ACCOMPLISHED WITH:
 STRAW OR HAY-2.5 TONS/ACRE
 WOOD WASTE, BARK, SAWDUST-2-3" DEEP (APPROX. 6-9 TONS/ACRE)

Ds2 TEMPORARY SEEDING

SPECIES	SEEDING SCHEDULE			LIME
	RATE/1000 S.F.	DATES		
WINTER RYE	1.5 - 2 LBS.	9/1 - 11/1, 3/1 - 4/1		1 TON/ACRE
*WEeping LOVEGRASS	2-3 LBS.	3/1 - 8/1		1 TON/ACRE

SPECIES	FERTILIZER (LBS./ACRE)		
	N2	P2O2	K2O2
WINTER RYE	60 - 90	120 - 180	120 - 180
*WEeping LOVEGRASS	60 - 90	120 - 180	120 - 180

Ds3 PERMANENT SEEDING

SPECIES	SEEDING SCHEDULE			LIME
	RATE/1000 S.F.	DATES		
HULLED BERMUDA	2 LBS.	10/1 - 3/1		1 TON/ACRE
UNHULLED BERMUDA	2 LBS.	2/15 - 6/15		1 TON/ACRE
FESCUE	5 - 10 LBS.	9/1 - 11/1		1 TON/ACRE

SPECIES	FERTILIZER (LBS./ACRE)		
	N2	P2O2	K2O2
HULLED BERMUDA	60 - 90	120 - 180	120 - 180
UNHULLED BERMUDA	60 - 90	120 - 180	120 - 180
FESCUE	60 - 90	120 - 180	120 - 180

Ds4 PERMANENT SOD